



**Lindelani Msomi**  
Candidate Property Practitioner  
Registered with PPRA (FFC 114 194 6)  
082 687 2035  
lindelanimsoni@dpg.co.za

Contact Pinetown

031 8229071

39 Glenugie Road  
Pinetown



SOLE MANDATE

Web Ref DPG2762918

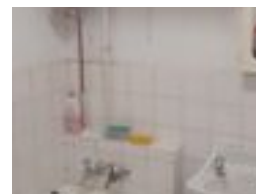

R675,000

🛏️ 2 🚿 1

**Monthly Bond Repayment** R6,967.27  
Calculated over 20 years at 11% with no deposit.

**Transfer Costs** R23,730.00    **Bond Costs** R17,680.00  
These calculations are only a guide. Please ask your conveyancer for exact calculations.

**Monthly Levy** R1,455    **Monthly Rates** R395

THIS WILL SELL NOW!

This newly renovated flat is ideal for investors. Wheelchair friendly as it is situated on the ground floor and closer to parkings. 2 Bedrooms (new bic's - newly tiled), family bath, newly fitted kitchen, open plan lounge/dining, enclosed balcony, parking.

Features

Interior		Exterior		Sizes	
Bedrooms	2	Carports / Parkings	1	Floor Size	73m <sup>2</sup>
Bathrooms	1	Security	Yes		
Recep. Rooms	1	Pool	No		

