



Yolanda Honiball
082 723 4850
yolandahoniball@dpg.co.za

Contact Vanderbijlpark / Sasolburg

016 0042353

Shop 2,
The Palms Shopping Center,
Louis Trichardt Blvd,
Vanderbijlpark,
1911

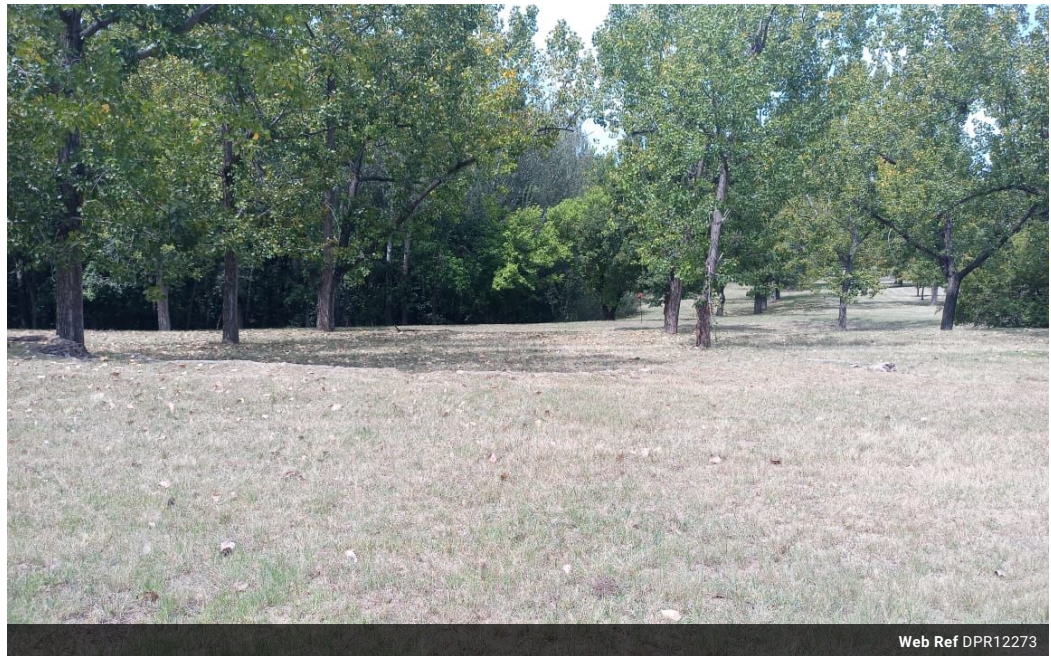

Web Ref DPR12273



R700,000

Monthly Bond Repayment R7,225.32
Calculated over 20 years at 11% with no deposit.

Transfer Costs R23,730.00 **Bond Costs** R17,680.00
These calculations are only a guide. Please ask your conveyancer for exact calculations.

Monthly Levy R4,000 **Monthly Rates** R300

Riverfront Stand For Sale!

Nestled amidst serene landscapes, this pristine parcel of vacant land presents an unparalleled opportunity to craft your very own sanctuary, a haven removed from the hustle and bustle of city life. Enveloped by the breathtaking beauty of nature and teeming with wildlife, this estate promises an idyllic retreat where tranquility reigns supreme.

Here, you have the opportunity to design and build the home of your dreams, tailored to your unique desires and aspirations. Whether you envision a rustic cabin nestled amidst towering trees or a contemporary abode with panoramic views of the surrounding landscape, the choice is yours. Embrace the freedom to create a lifestyle that resonates with your soul, where every sunrise brings the promise of new beginnings, and every sunset paints the sky in hues of gold and crimson. With its...

Features