



**Edward Letsele**  
 084 850 2645  
 edwardletsele@dpg.co.za

Contact Vanderbijlpark / Sasolburg

016 0042353

Shop 2,  
 The Palms Shopping Center,  
 Louis Trichardt Blvd,  
 Vanderbijlpark,  
 1911



Web Ref DPR15354

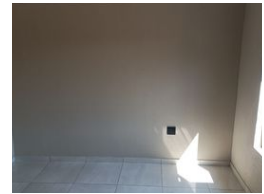

**R832,000**

**Monthly Bond Repayment** R8,587.81  
 Calculated over 20 years at 11% with no deposit.

**Transfer Costs** R28,244.00    **Bond Costs** R21,450.00

These calculations are only a guide. Please ask your conveyancer for exact calculations.

3    2

**Customize Your Dream Home Today**

Discover the perfect opportunity to build your dream home on this 264 square meter plot, offering a variety of customizable plans to suit your lifestyle. Choose from three thoughtfully designed options: a 60 square meter home priced at R832,000, a 70 square meter home for R882,000, or an 80 square meter home at R942,000.

Each plan includes three bedrooms and two bathrooms, providing ample space for comfortable living. This plot and plan option allows you to tailor your home to your preferences while enjoying the benefits of modern design and efficient use of space.

**Features**

<b>Pets Allowed</b>	Yes				
<b>Interior</b>		<b>Exterior</b>		<b>Sizes</b>	
Bedrooms	3	Security	Yes	Floor Size	60m <sup>2</sup>
Bathrooms	2	Pool	No	Land Size	246m <sup>2</sup>
Kitchens	1	Views	False		
Recep. Rooms	1				
Furnished	No				

