



Edward Letsele
 084 850 2645
 edwardletsele@dpg.co.za

Contact Vanderbijlpark / Sasolburg

016 0042353

Shop 2,
 The Palms Shopping Center,
 Louis Trichardt Blvd,
 Vanderbijlpark,
 1911



Web Ref DPR15361

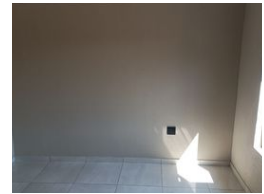

R690,000

🛏️ 2 🚿 1

Monthly Bond Repayment R7,122.10
 Calculated over 20 years at 11% with no deposit.

Transfer Costs R23,730.00 **Bond Costs** R17,680.00
 These calculations are only a guide. Please ask your conveyancer for exact calculations.

Customize Your Dream Home Today

Discover the perfect opportunity to build your dream home on this 308 square meter plot, offering a variety of customizable plans to suit your lifestyle. Choose from three thoughtfully designed options: a 40 square meter home priced at R690 000, a 45 square meter home for R715 000, or an 50 square meter home at R750 000, or an 60 square meter home at R808 000.

Three plan includes two bedrooms and one bathrooms, providing ample space for comfortable living and one plan includes three bedrooms and two bathrooms. This plot and plan option allows you to tailor your home to your preferences while enjoying the benefits of modern design and efficient use of space.

Features

Pets Allowed	Yes			
Interior		Exterior		Sizes
Bedrooms	2	Security	Yes	Floor Size
Bathrooms	1	Pool	No	Land Size
Kitchens	1	Views	False	40m ²
Recep. Rooms	1			308m ²
Furnished	No			

